

4.1 VERGLEICHENDE DARSTELLUNG

Abgebrochene, auch translozierte Gebäude seit 1940

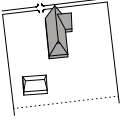

A1

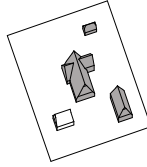

A2

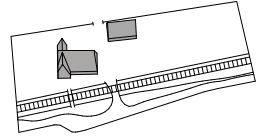

M1

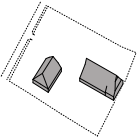

M2

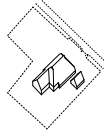

S1

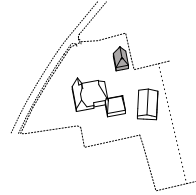

S2

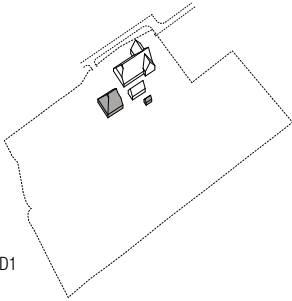

D1

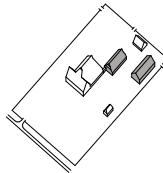

D2

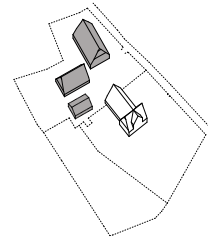

W1

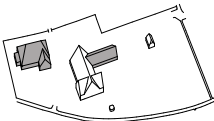

W2

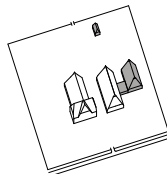

W3

4-01

Elf Höfe 1940. Genordnete Grundriss-Axonometrien.

Grau: abgebrochene, auch translozierte Gebäude seit 1940.

Lüder, Herrera, 2018. Datengrundlage: Wolf 1979; © Geobasis-DE/LVermGeo SH 2015 ALKIS; Aufmaß.

Nach 1940 gebaute, auch translozierte, und heute noch bestehende Gebäude

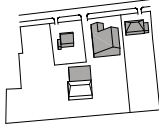

A1

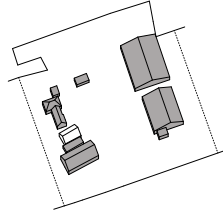

A2

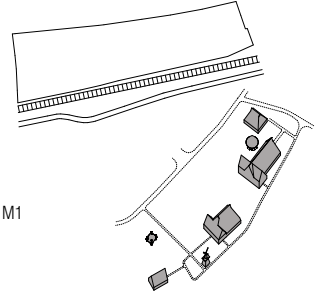

M1

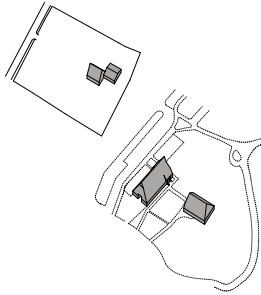

M2

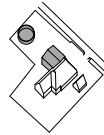

S1

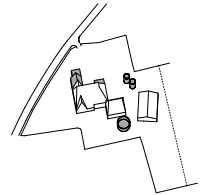

S2

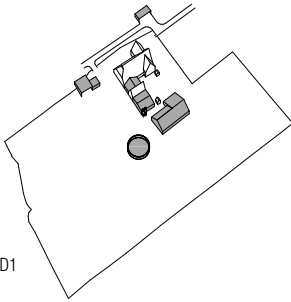

D1

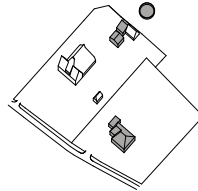

D2

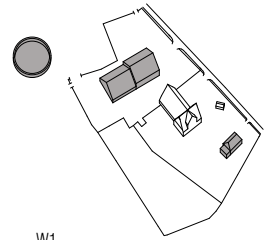

W1

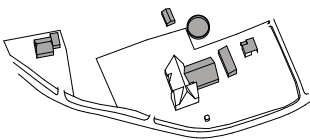

W2

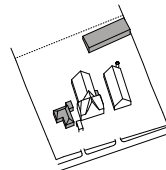

W3

4-O2

Elf Höfe 2018. Genordnete Grundriss-Axonometrien.
 Grau: nach 1940 gebaute, auch translozierte, und heute noch bestehende Gebäude.
 Lüder, Herrera, 2018. Datengrundlage: © Geobasis-DE/LVermGeo SH 2015 ALKIS; Aufmaß.

Reetdächer 1940

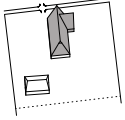

A1

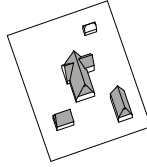

A2

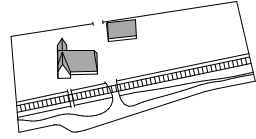

M1

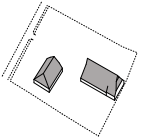

M2

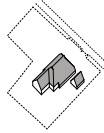

S1

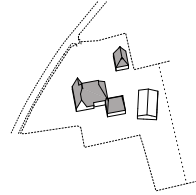

S2

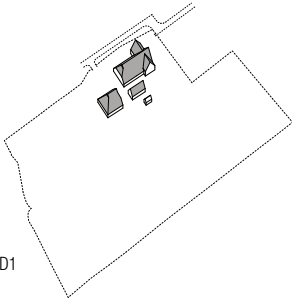

D1

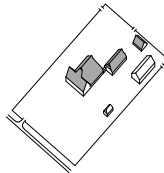

D2

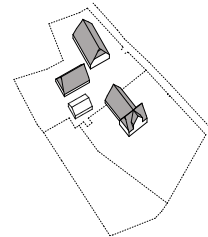

W1

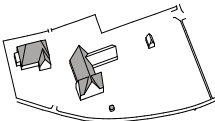

W2

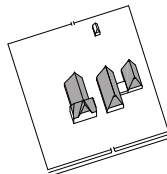

W3

4-03

Elf Höfe 1940. Genordnete Grundriss-Axonometrien. Grau: Reetdächer.

Lüder, Herrera, 2018. Datengrundlage: Wolf 1979; © Geobasis-DE/LVermGeo SH 2015 ALKIS; Aufmaß.

Reetdächer 2018

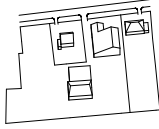

A1

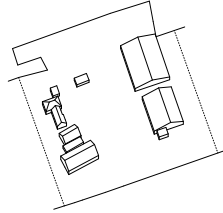

A2

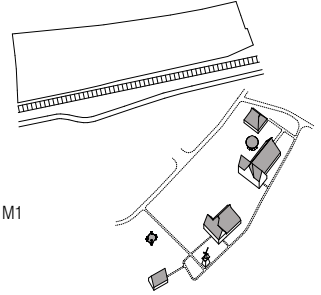

M1

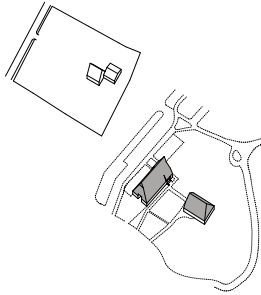

M2

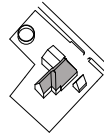

S1

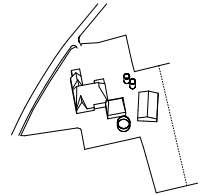

S2



D1

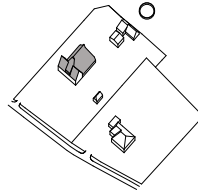

D2

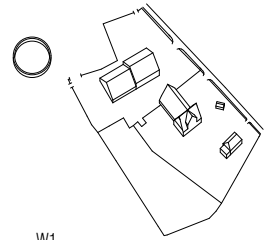

W1

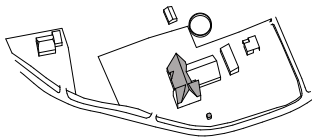

W2

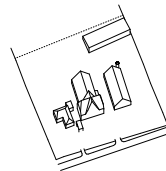

W3

Landwirtschaftliche Betriebe und kleinmaßstäbliche Landwirtschaft 2018

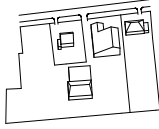

A1

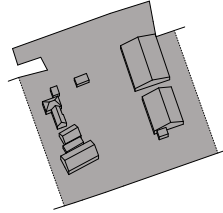

A2

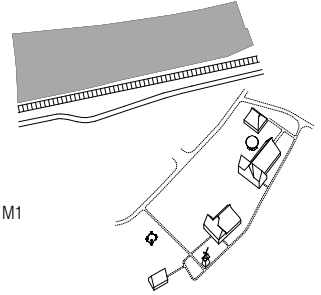

M1

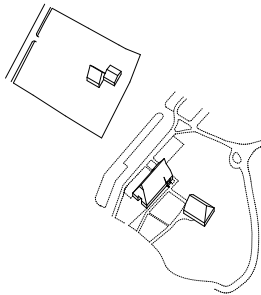

M2

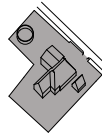

S1

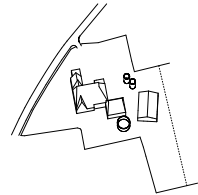

S2 keine Angabe

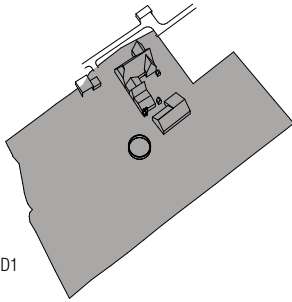

D1

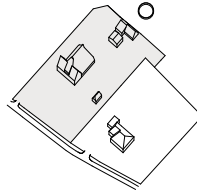

D2

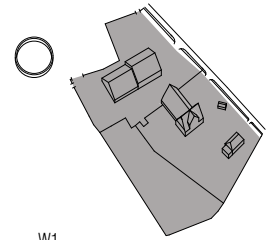

W1

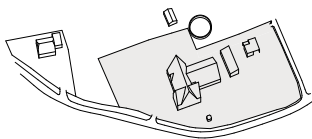

W2

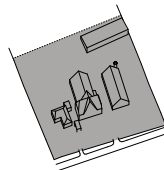

W3

4-05

Elf Höfe 2018. Genordnete Grundriss-Axonometrien.
 Grau: landwirtschaftliche Betriebe. Hellgrau: kleinmaßstäbliche Landwirtschaft.
 Lüder, Herrera, 2018. Datengrundlage: © Geobasis-DE/LVermGeo SH 2015 ALKIS; Aufmaß.

Tierhaltung im Gebäude 2018

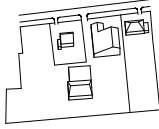

A1

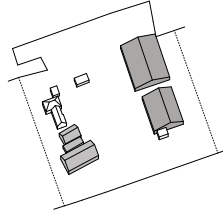

A2

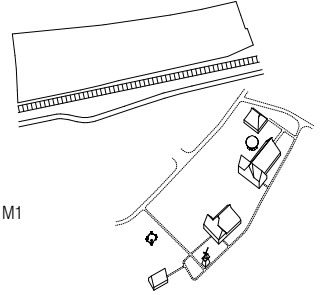

M1

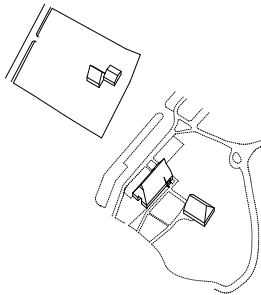

M2

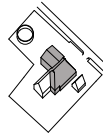

S1

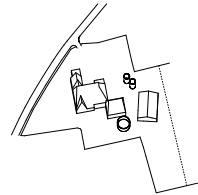

S2 keine Angabe

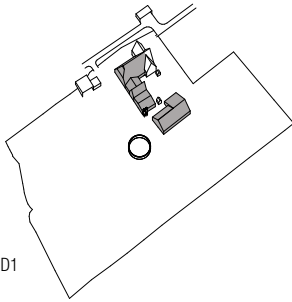

D1

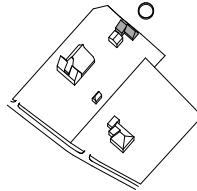

D2

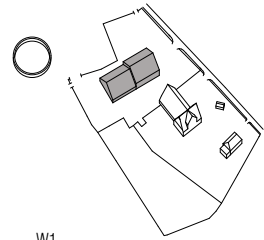

W1

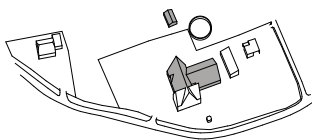

W2

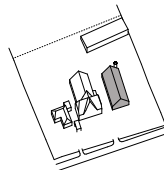

W3

Grundrisse 1940

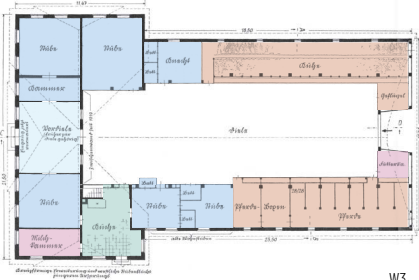

W3

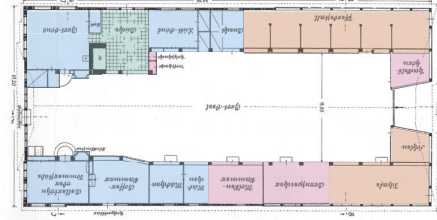

M2

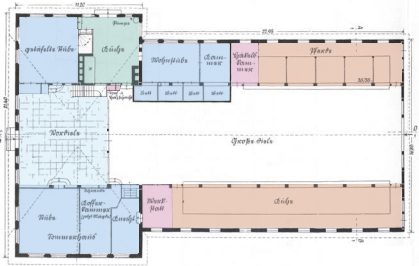

W2

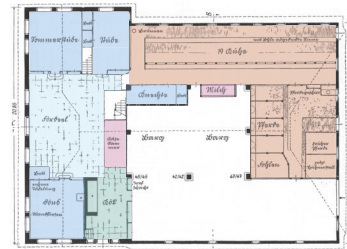

D2

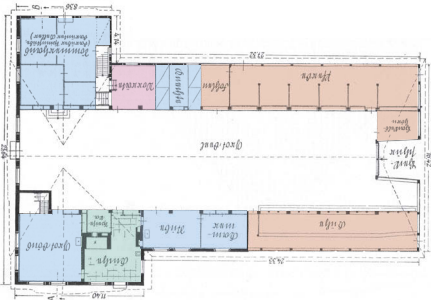

M1

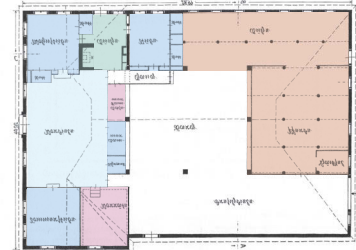

S2

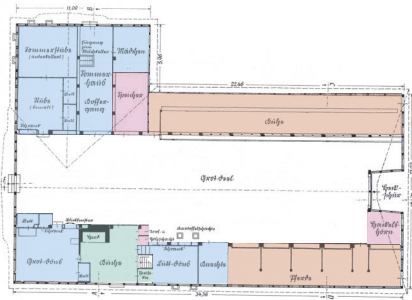

A1



S1

4-07
Grundrisse von Fachhallen- und Barghäusern 1940 mit markierten Nutzungen.
Kitzler, Ruckelshauß, Wallies, Herpin, Pohl. Aus Wolf 1979 (bearbeitet Lüder, 2019).

Grundrisse 2018



W3

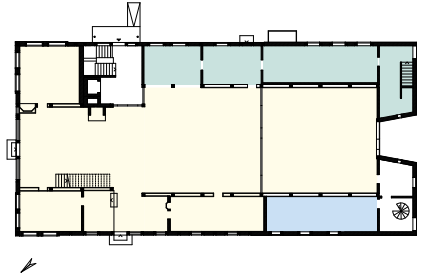

M2



W2



D2

- Wohnräume, Büros
- Vordielen
- Küchen
- Bäder
- Wirtschafts-, Technikräume
- Tierhaltung
- Gastraum Restaurant
- ohne Farbe: Dielen, Bargräume, Verkehrsflächen,
Lager, ungenutzte Räume

